

DIMENSIONS mm (inches)

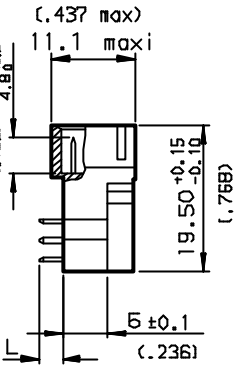
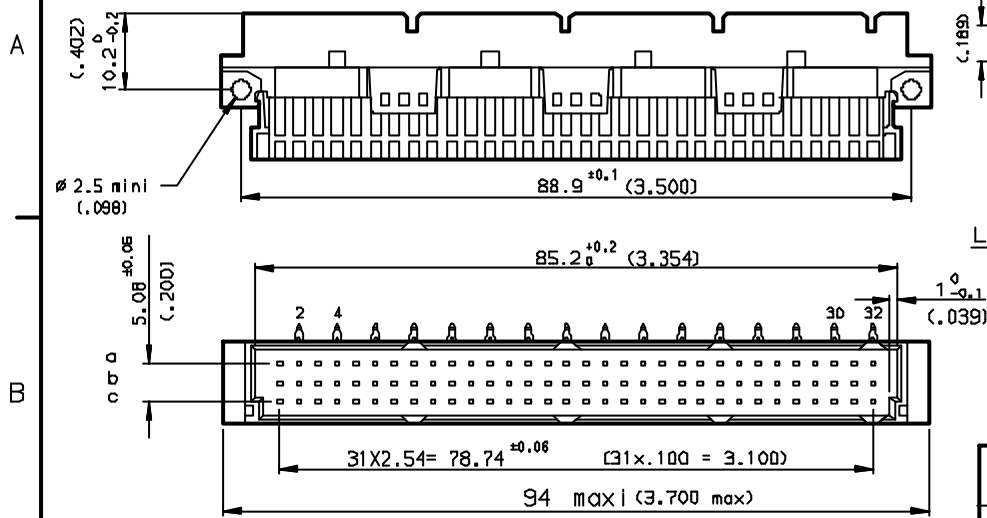

PART NUMBER	8609			71		7		8	
PIN OUT									
rows a-b-c				3		48			
rows a-c				4		32			
NUMBER OF CONTACTS									
TERMINATION									
L = 2.80 ± 0.20 (.110)						short post			94
PERFORMANCE CLASS									
DIN 41612 class 3									4
DIN 41612 class 2									5
DIN 41612 class 1									6
TERMINATION TYPE									000E1
TIN LEAD									ETLF
LEAD FREE									

METHOD OF INSERTION ON THE PCB = FLAT ROCK

ATTENTION
Minimum gap: 1mm (.039)

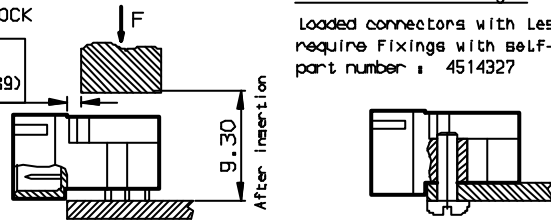

Recommended accessory :

Loaded connectors with less than 64 cts require fixings with self-winding screws part number : 4514327

GENERAL CHARACTERISTICS AND ROHS INFORMATIONS:
SEE DRAWING C-8609-0000C

PCB DRILLING

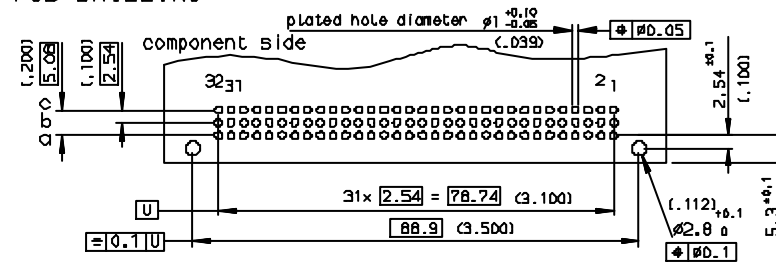

rev	con no	in	date
C	-	ROU	2001/08/06
D	LS05-004	JTA	2005/02/11
E	LS05-0085	LGO	2006/06/22
-	-	-	-
-	-	-	-
-	-	-	-

www.fciconnect.com		surface ISO 1302 ✓	tolerance std ISO 406 ISO 1101	projection mm
Dr ROVILLARD 1997/10/28		TOLERANCES UNLESS OTHERWISE SPECIFIED		size A3
Eng TARON 1997/10/28	ANGULAR	LINEAR	0.X ± 0.1	Scale 1.5
Chr LEGARE 1997/10/28	0.XX ± 0.1	0.XXX ± 0.1	ECN LS05-0085	Spec ref -
Appr LEGARE 1997/10/28	Product Family DIN 8609		Rev. E	
FCi		RIGHT ANGLE MALE - STYLE C		Rev. E
PRESS FIT		C-8609-0632		sheet 1 of 1
catalog no		CUSTOMER		

European Views