

PART NO	CKT	DIM A	DIM B	DIM C	DIM D	DIM E	DIM F
151053-0001	2	33.90	30.84	28.20	14.10	7.25	34.90
151053-0003	3	44.90	41.84	39.20	19.60	12.75	45.90
151053-0004	4	55.90	52.84	50.20	25.10	18.25	56.90
151053-0005	5	66.90	63.84	61.20	30.60	23.75	67.90
151053-0006	6	77.90	74.84	72.20	36.10	29.25	78.90

- NOTES:
- MATERIAL:
HOUSING: LCP, UL94V-0, COLOR: BLACK
TERMINALS: COPPER ALLOY
 - FINISHES: TERMINALS : 304N MIN GOLD ON CONTACT
1004N MIN TIN ON TAIL
504N MIN NICKEL UNDERPLATE OVERALL.
 - PRODUCT SPECIFICATION: PS-151053-0000
 - PACKAGING SPECIFICATION: PK-151053-0001
 - MATING WITH CRIMP: 46819, CRIMP RECEPTACLE HOUSING: 151034
 - TAIL DESIGN : COMPLIANT PIN
 - PLATED THRU HOLE SIZE, REFER TO PS-151053-0000
 - RECOMMENDED SCREW: 2-32 TYPE AB X 0.300".
SCREWS ARE SOLD SEPARATELY.
 - USE FLAT ROCK APPLICATION TOOLING.
 - POWER CONTACTS ARE LUBRICATED.

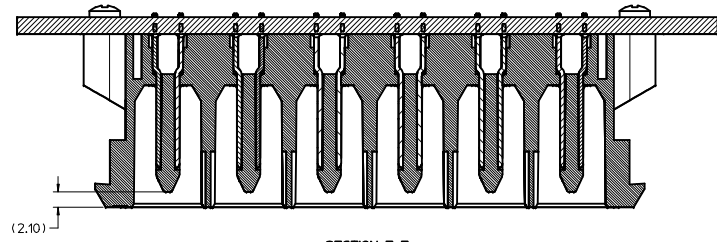
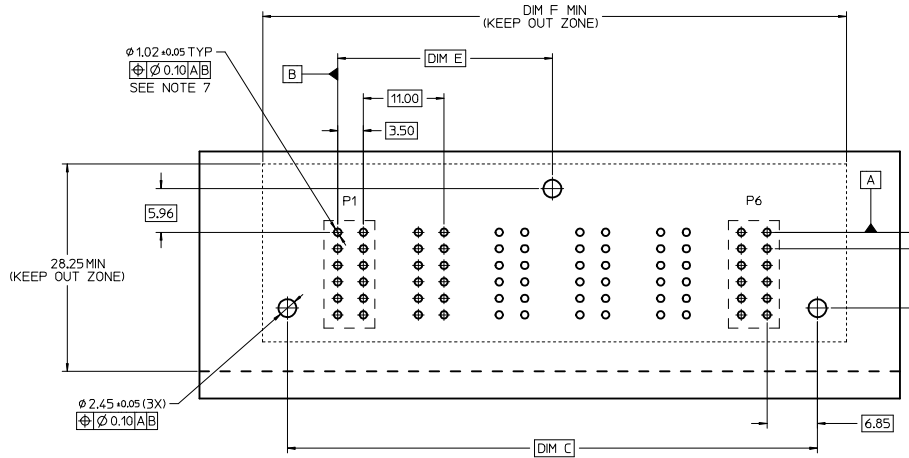
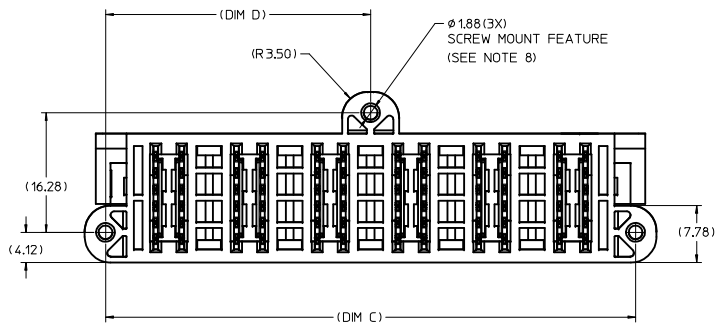
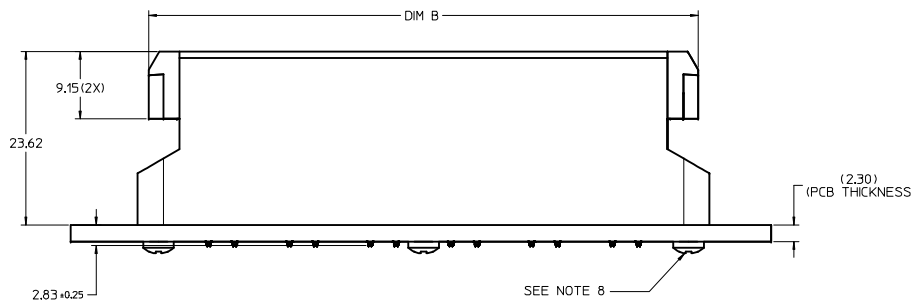

THIS DESIGN IS BASED ON DESIGN OBJECTIVES AND IS STRICTLY TENTATIVE. IT MAY CHANGE BASED ON RESULTS OF ADDITIONAL DESIGN REVIEWS & VERIFICATIONS.

ADD OPTION IEC NO: SZ015-1209 DRAWN: CGOH 2015/08/14 CHECKED: GMENARLY 2015/08/14 APPR: KHLIM 2015/08/14	QUALITY SYMBOLS ∇=0 ∇=0 ∇=0	GENERAL TOLERANCES (UNLESS SPECIFIED): mm INCH		DIMENSION STYLE MM ONLY	SCALE 3:1	DESIGN UNITS METRIC	THIRD ANGLE PROJECTION
		4 PLACES ± --- ± --- 3 PLACES ± --- ± --- 2 PLACES ± 0.25 ± --- 1 PLACE ± 0.25 ± --- 0 PLACE ± --- ± ---	ANGULAR ± 3 ° DRAFT WHERE APPLICABLE MUST REMAIN WITHIN DIMENSIONS	DRAWN BY CGOH DATE 2015/01/22	CHECKED BY GMENARLY DATE 2015/01/22	APPROVED BY KHLIM DATE 2015/08/14	TITLE 2 - 6CKT VERTICAL HEADER POWER CONNECTOR molex
MATERIAL NO: SEE TABLE		DOCUMENT NO: SD-151053-0001		SHEET NO: 1 OF 1			

THIS DRAWING CONTAINS INFORMATION THAT IS PROPRIETARY TO MOLEX INCORPORATED AND SHOULD NOT BE USED WITHOUT WRITTEN PERMISSION