

THIS DRAWING IS UNPUBLISHED. RELEASED FOR PUBLICATION, 19 .
 © COPYRIGHT 19 BY AMP INCORPORATED. ALL INTERNATIONAL RIGHTS RESERVED.

MOD	LOC	DIST	P	F	ZONE	LTR	DESCRIPTION	DATE	APPD
1	BD	20				E	REVISED & REDRAWN PER SP-46	8-27-87	-
						F	REVISED ECN-SP-85	2-11-88	-
						G	REVISED ECN BD2801	2-16-89	RW
						H	OBSOLETE -6 PER EC 0020-894-94	08/17/94	AT
						J	OBS -4 PER EC 0020-1416-94	11/25/94	AT

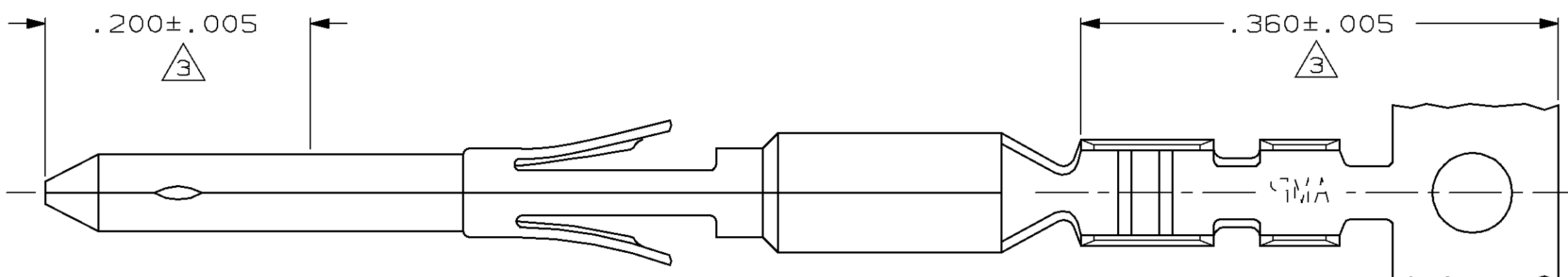

1. WIRE RANGE: #24 - #20 AWG.
2. INSULATION RANGE: .054 - .036 DIA.
3. DUPLEX PLATED .000150 MIN. TIN/LEAD ON WIRE BARREL END FOR LENGTH OF .360, .0000150 MIN. THK. GOLD ON MATING END FOR A LENGTH OF .200 WITH ENTIRE CONTACT UNDERPLATED .000100 MAX. THK. NICKEL.
4. TIN PLATE .000050 MIN. THK OVER NICKEL.
5. SILVER PLATE .000100 MIN. THK. OVER COPPER.
6. OBSOLETE PART NUMBER.

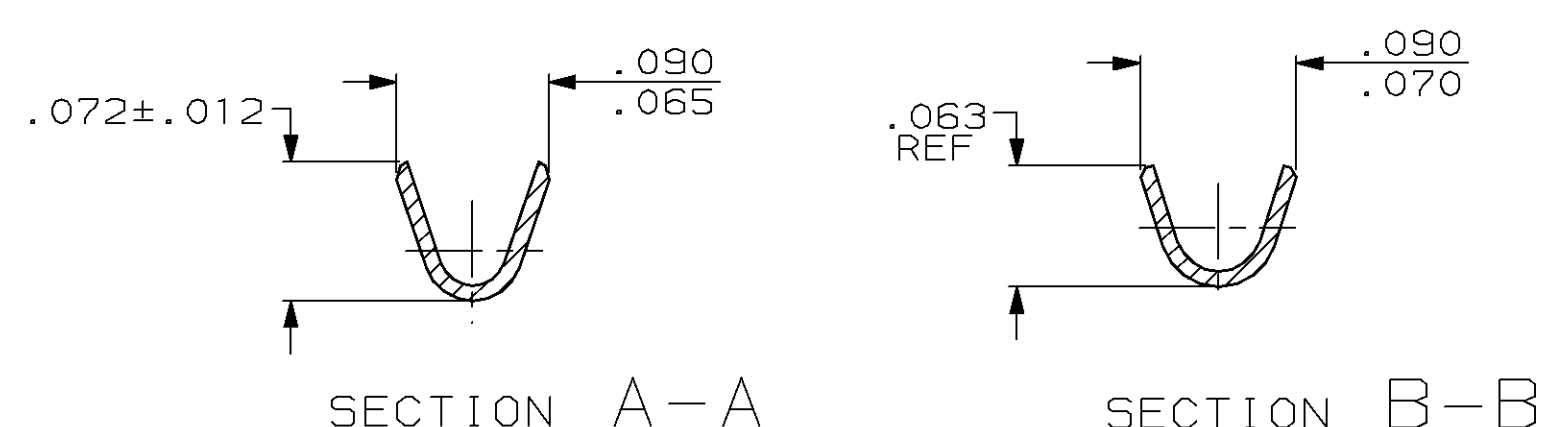
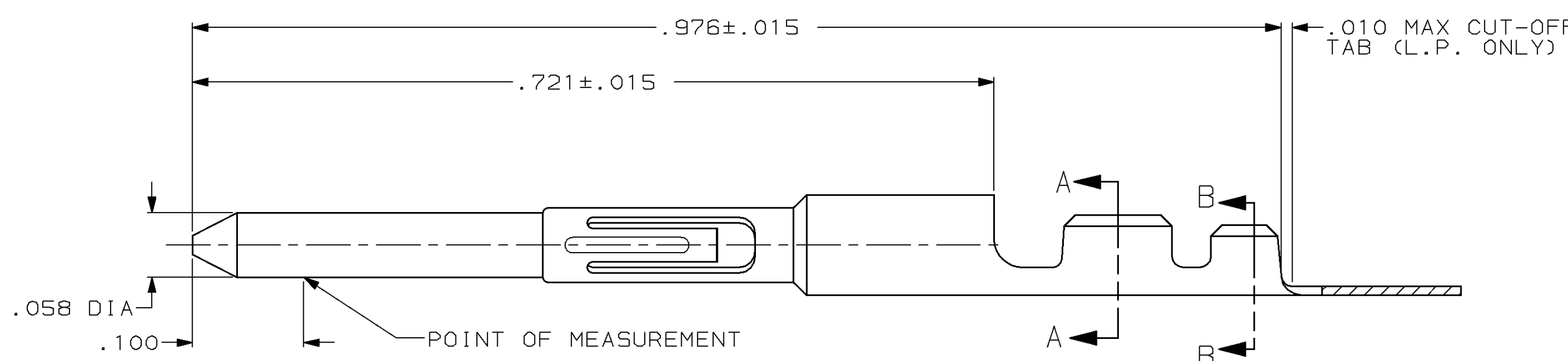

LOOSE PIECE P/N	FINISH	PART NO
-	5	66735-6
6 66735-4	4	66735-2
6 66735-3	3	66735-1

DO NOT SCALE PRINT. UNLESS SPECIFIED DIMENSIONS IN INCHES TOLERANCES ON: 2 PLC DEC ± - 3 PLC DEC ± - ANGLES ± -	DR 10-6-87 L.SIPE CHK 10-13-87 S.WELDON APPD 10-13-87 D.NEIDIG APPD 10-13-87 V.KUMAR	AMP Incorporated Harrisburg, PA 17105-3608	
MATERIAL BRASS PER MIL-C-50	PRODUCT SPEC -	NAME CIRCULAR DIN, PIN CONTACT	
FINISH SEE TABLE	APPLICATION SPEC -	SIZE C 00779	DRAWING NO C=66735
	WEIGHT -	SCALE 10:1	SHEET 1 OF 1

THIS DRAWING IS A CONTROLLED DOCUMENT FOR AMP INCORPORATED. IT IS SUBJECT TO CHANGE AND THE CONTROLLING ENGINEERING ORGANIZATION SHOULD BE CONTACTED FOR THE LATEST REVISION.